



# TITAN ACT WHEEL SYSTEM

> **WHEELS THAT KEEP YOU MOVING**



*“Every time those tires are changed, the ACT wheels are saving us money. They’ve been well worth the money we’ve spent, and above and beyond that. They’re producing income for us now.”*

— **Freddy Hunt**  
General manager, MS&R, Cedar Lake Mine

## LESS DOWNTIME, MORE PROFIT

Titan pioneered an industry-changing design known as the Accelerated Change Technology (ACT) wheel. The system allows the inner tire to be removed without having to remove the outer wheel, which reduces downtime associated with tire changes or rotations by up to 50 percent.

## RETURN ON INVESTMENT

A Nevada gold mine switched from standard wheel systems to the ACT wheel system and saw a dramatic reduction in downtime.

- ▶ **Yield:** 250 tons per load yields approximately 250 ounces of gold valued at \$331,562.50.
- ▶ **Earnings:** Running 24 hours per day, the mine hauls one load every two hours, resulting in hourly earnings of \$165,781.25.
- ▶ **Downtime:** Tires are rotated or changed four times a year. Before the ACT wheel, the process took five hours. ACT reduced that downtime to 3.5 hours — saving 14 hours per year, per truck.
- ▶ **Increased production:** Hourly earnings of \$165,781.25 times 14 hours saved equals \$2,320,937.50 per truck, per year.

## HOW IT WORKS

The ACT wheel system has a two-piece lock ring that can release the tire assembly from the wheel while the outer wheel stays mounted to the truck. The ACT wheel eliminates the need for the outside wheel to be removed — all the bolts stay on and there's no need to torque the wheel.

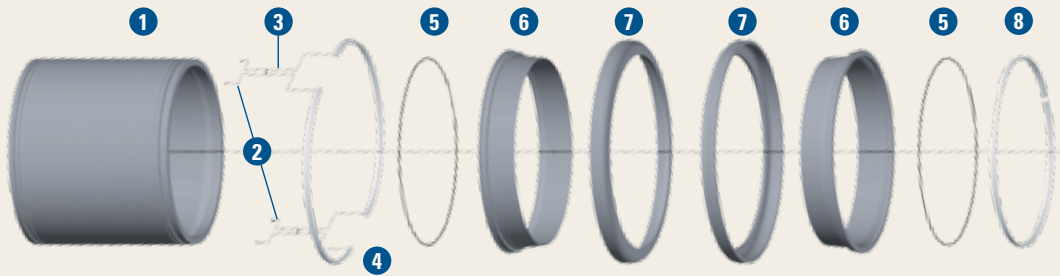

- 1 Wheel (qty. 1)
- 2 Bolt (qty. 8)
- 3 Lock plate (qty. 4)
- 4 2-piece lock ring (qty. 2)
- 5 O-ring (qty. 2)
- 6 Bead seat (qty. 2)
- 7 Side ring (qty. 2)
- 8 Single-piece lock ring (qty. 1)

Same components used on both Titan EHD and ACT.

- ▶ **Step 1:** Deflate inner and outer tires.
- ▶ **Step 2:** The lock ring is removed from the wheel and the tire is pulled off. Once the tire is off, the lock ring on the inside wheel is removed.
- ▶ **Step 3:** The pry-bar will be inserted into the slot. The inside tire will be pulled over both wheels.
- ▶ **Step 4:** Then new tires are installed. Once the new inside tire is in place, the two-piece lock ring is installed.
- ▶ **Step 5:** Outside tire is placed on the wheel.
- ▶ **Step 6:** Finally, the last two-piece lock ring is secured.

### THE ACT WHEEL PROVIDES THE FOLLOWING ADDITIONAL BENEFITS:

- ▶ When partnered with the sturdy quality of Titan extra heavy duty (EHD) tires, the ACT helps maximize productivity
- ▶ Reduces manual handling
- ▶ Improves overall safety

### THE TITAN ACT WHEEL SYSTEM IS COMPATIBLE WITH THE FOLLOWING MODELS:

- ▶ **CAT:** 769, 771, 773, 775, 777, 785, 789, 793, 797
- ▶ **Komatsu:** HD325, HD405, HD465, HD465-7, HD605, 785, 1500-7, 730, 830, 860, 930
- ▶ **Hitachi:** EH1700-3, EH1500-7, EH3500, EH4000, EH5000

For more information about the Titan ACT wheel system, contact your local Titan OTR representative at [OTRspecialist@titan-intl.com](mailto:OTRspecialist@titan-intl.com). An informational video on the system is also available at [www.youtube.com/TitanGoodyear](http://www.youtube.com/TitanGoodyear).

